

Blind Flanges

ANSI B16.5

300 Lbs

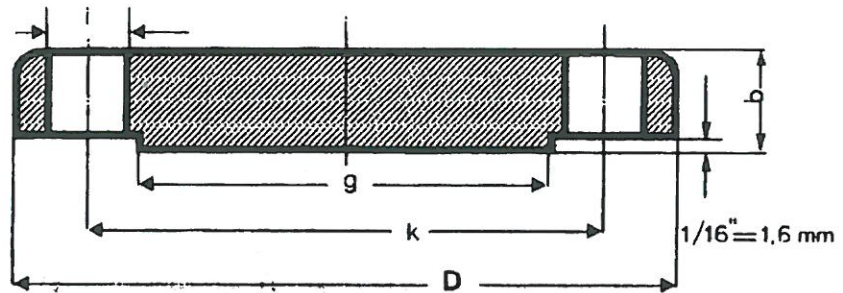

nominal pipe size	outside diam. of flange D	thickness of flange b	diam. of raised face g	drilling template			stud bolts			approx. weight kilo
				diam. of bolt circle k	n° of holes	diam. of bolt holes i	diam.	length		
								1/16" raised face	ring joint	
1/2"	95.2	14.3	34.9	66.7	4	15.9	1/2	2 3/4	3	1.0
3/4"	117.5	15.9	42.9	82.5	4	19.0	5/8	3	3 1/2	1.4
1"	123.8	17.5	50.8	88.9	4	19.0	5/8	3 1/4	3 3/4	1.8
1 1/4"	133.3	19.0	63.5	98.4	4	19.0	5/8	3 1/4	3 3/4	2.7
1 1/2"	155.6	20.6	73.0	114.3	4	22.2	3/4	3 3/4	4 1/4	3.2
2"	165.1	22.2	92.1	127.0	8	19.0	5/8	3 1/2	4 1/4	3.6
2 1/2"	190.5	25.4	104.8	149.2	8	22.2	3/4	4	4 3/4	5.4
3"	209.5	28.8	127.0	168.3	8	22.2	3/4	4 1/4	5	7.3
3 1/2"	228.6	30.2	139.7	184.1	8	22.2	3/4	4 1/2	5 1/4	9.8
4"	254.0	31.7	157.2	200.0	8	22.2	3/4	4 1/2	5 1/4	12.2
5"	279.4	34.9	185.7	234.9	8	22.2	3/4	4 3/4	5 1/2	15.9
6"	317.5	36.5	215.9	269.9	12	22.2	3/4	5	5 3/4	22.7
8"	381.0	41.3	269.9	330.2	12	25.4	7/8	5 1/2	6 1/4	37.0
10"	444.5	47.6	323.8	387.3	16	28.6	1	6 1/4	7	58.0
12"	520.7	50.8	381.0	450.8	16	31.7	1 1/8	6 3/4	7 1/2	84.0
14"	584.2	54.0	412.7	514.3	20	31.7	1 1/8	7	7 3/4	107.0
16"	647.7	57.1	469.9	571.5	20	34.9	1 1/4	7 1/2	8 1/4	139.0
18"	711.2	60.3	533.4	628.6	24	34.9	1 1/4	7 3/4	8 1/2	177.0
20"	774.7	63.5	584.2	685.8	24	34.9	1 1/4	8 1/4	9	223.0
22"	838.2	66.7	641.2	742.9	24	41.3	1 1/2	9 1/4	10 1/4	270.0
24"	914.4	69.8	692.1	812.8	24	41.3	1 1/2	9 1/4	10 1/4	342.0